

Product overview

Safety in system: Protection for man and machine.



SCHMERSAL

Safe solutions for your industry

Introduction



Dipl.-Ing. Heinz Schmersal and Dipl.-Wirt.-Ing. Philip Schmersal
Managing Associates of the K.A. Schmersal GmbH & Co. KG

How does one introduce a new customer or an interested designer to a portfolio of around 25,000 products and diverse but always complex services? Our sales engineers are faced with this question whenever they need to talk about our company and its range of services.

This brochure should give you an initial overview of what you can expect from us. It describes the company and the individual product groups where we have been developing complete solutions for machine safety over recent years. We are ever more focused on the qualified services we can offer you and which, in conjunction with our products and solutions, embody our key objective. It is our desire to provide you with up to date safety engineering solutions, thereby making the world a little safer.

Heinz Schmersal

Philip Schmersal

Content

Introduction	Page 02
Content	Page 03
1. History	Page 04
2. Schmersal Worldwide	
2.1 Offices	Page 05
2.2 Offices in Germany	Page 06
2.3 International Offices	Page 07
3. Strategic Development	Page 08
4. Commitments and Responsibility	Page 09
5. Industry Solutions	
5.1 Food	Page 10
5.2 Packaging	Page 11
5.3 Lifts and Escalators	Page 12
5.4 Heavy Industry	Page 13
5.5 Machine Tools	Page 14
5.6 Automobile	Page 15
6. Services	Page 16
7. Products	
7.1 Application Finder	Page 18
7.2 Safety Door Monitor	Page 20
7.3 Optical Protective Gear	Page 22
7.4 Control Devices with Safety Functions	Page 24
7.5 Safety-Related Tactile Sensors	Page 26
7.6 Safe Signal Processing	Page 27
7.7 AS Interface Safety at Work	Page 28
7.8 Position and Limit Switches, Sensors	Page 30
7.9 Switchgear for Explosion Protection	Page 31
7.10 Control and Signalling Devices	Page 32

1. History

Milestones 1945 – 2013



Schmersal Brazil 1974



Schmersal China 2013



Startup of the new central warehouse in 2013

1945

The brothers Kurt Andreas Schmersal and Ernst Schmersal **form** the company in Wuppertal.

1950s

The **product portfolio** is continuously expanded. Many switchgears are used in safety related applications such as in explosive areas.

1970s

Schmersal is one of the first companies to begin development and production of **electronic proximity switches**.

1974

ACE Schmersal is formed in Boituva, Brazil.

1982

Generational change: Heinz and Stefan Schmersal take over the company from their fathers.

1994

Schmersal takes over **steute Schaltgeräte GmbH** based in Löhne.

1997

ELAN Schaltelemente GmbH & Co. KG based in Wettenberg is acquired.

1999

The production facility **Schmersal Industrial Switchgear Co. Ltd** (SISS) is formed in Shanghai, China.

2004

Heinz Schmersal takes over 100% of the Group.

2007

Philip Schmersal joins the **third generation of the** Schmersal Group.
The training centre **tec.nicum** is formed.

2008

The **company kindergarten** starts with 18 children.
In October 2008 the Schmersal Group takes over **Safety Control GmbH** and its affiliate Protec GmbH in Mühldorf/Inn.

2013

ELAN Schaltelemente merges with the Schmersal Group and the resulting entity is renamed **K.A. Schmersal GmbH & Co. KG**.
Böhnke + Partner Steuerungssysteme GmbH is acquired.
Schmersal India becomes a production facility.
Startup of the new **European central warehouse** in Wuppertal.

2. Schmersal Worldwide

2.1 Offices

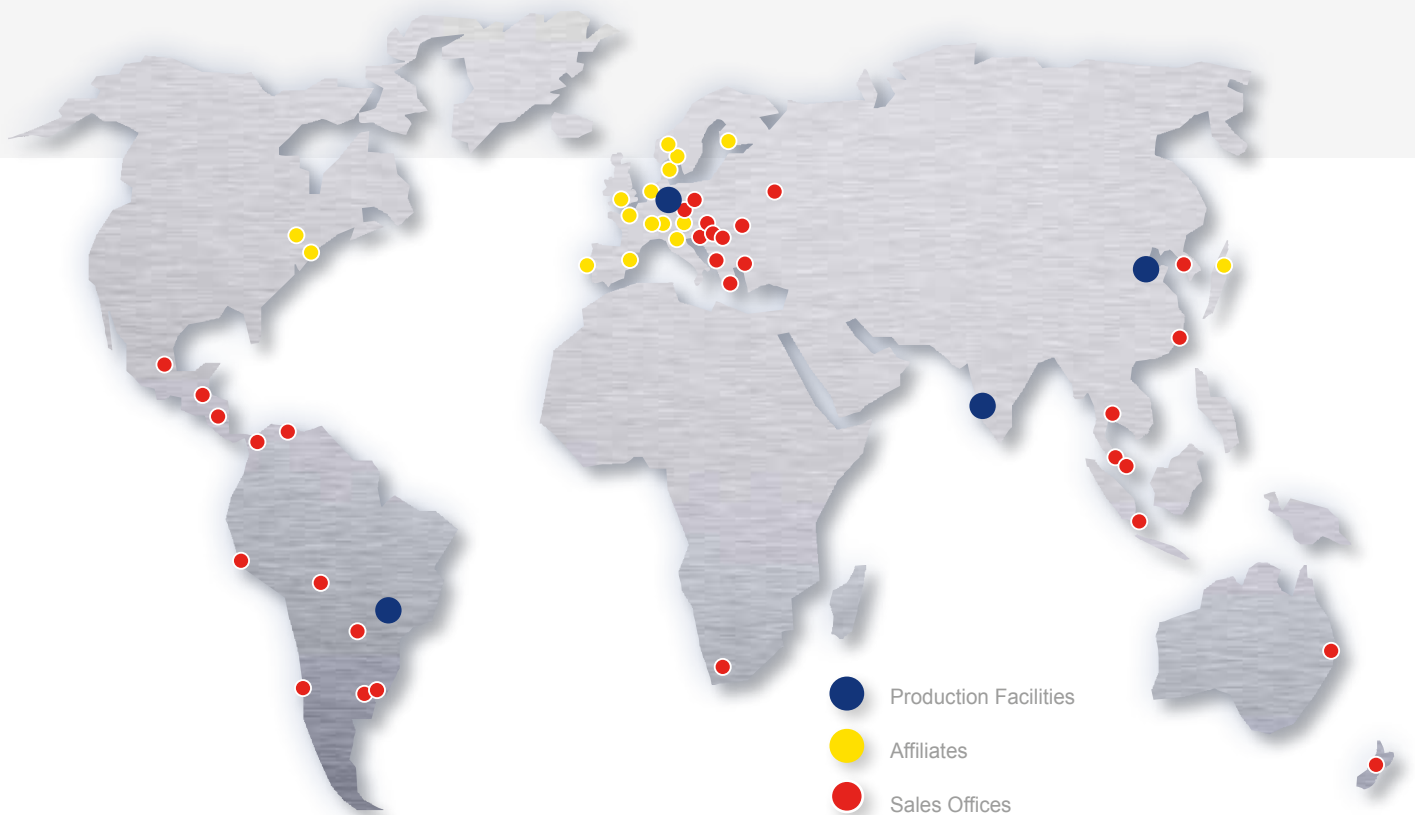

With its own affiliates in around 20 countries and capable sales and service partners in 30 more countries, the Schmersal Group has operations worldwide.

We started opening foreign sales, consultation and production offices early on. It is also for this reason that we are a sought-after partner of machine building and plant engineering firms with global operations as well as a recognised partner of medium size mechanical engineering companies with operations in Germany. Wherever machines with Schmersal safety switches are running, our next branch or office is not far away.

- | | | |
|----------------------------------|------------------------------------|---------------------------------|
| ■ Germany, Wuppertal | ■ Switzerland, Arni | ■ Macedonia, Skopje |
| ■ Germany, Wettenberg | ■ Spain, Sant Cugat | ■ Mexico, Mexico City |
| ■ Germany, Mühlendorf | ■ Sesgarrigues | ■ New Zealand, Christchurch |
| ■ Germany, Bergisch Gladbach | ■ USA, Tarrytown NY | ■ Pakistan, Islamabad |
| ■ Brazil, Boituva | | ■ Paraguay, Minga Guazú |
| ■ China, Shanghai | | ■ Peru, Lima |
| ■ India, Ranjangaon | ■ Argentina, Buenos Aires | ■ Poland, Warsaw |
| | ■ Australia, Brisbane | ■ Romania, Sibiu |
| | ■ Bolivia, Santa Cruz de la Sierra | ■ Russia, Moscow |
| | ■ Bulgaria, Ruse City | ■ Serbia, Belgrade |
| ■ Belgium, Aarschot | ■ Chile, Santiago | ■ Singapore, Singapore |
| ■ Denmark, Ballerup | ■ Costa Rica, San José | ■ South Africa, Johannesburg |
| ■ Finland, Helsinki | ■ Greece, Athens | ■ Taiwan, Taichung |
| ■ France, Seyssins | ■ Honduras, Choloma | ■ Thailand, Bangkok |
| ■ United Kingdom, Worcestershire | ■ Indonesia, Jakarta | ■ Czech Republic, Prague |
| ■ Italy, Borgosatollo | ■ Iceland, Reykjavik | ■ Turkey, Istanbul |
| ■ Japan, Tokyo | ■ Israel, Petah Tikva | ■ Ukraine, Kiev |
| ■ Canada, Brampton | ■ Colombia, Medellín | ■ Hungary, Győr |
| ■ Netherlands, Harderwijk | ■ South Korea, Seoul | ■ Uruguay, Montevideo |
| ■ Norway, Oslo | ■ Croatia, Zagreb | ■ United Arab Emirates, Sharjah |
| ■ Austria, Vienna | ■ Malaysia, Rawang | ■ Venezuela, Caracas |
| ■ Portugal, Póvoa de Sta. Iria | | ■ Vietnam, Hanoi |
| ■ Sweden, Mölnlycke | | |

2. Schmersal Worldwide

2.2 Offices in Germany

Wuppertal



K.A. Schmersal GmbH & Co. KG

- Founded in 1945
- Around 600 employees

Focal points

- Headquarters of the Schmersal Group
- Development and manufacture of switchgears and switching systems for safety, automation and lift engineering
- Accredited test laboratory
- Central research and development
- Logistics centre for European markets

Wettenberg



K.A. Schmersal GmbH & Co. KG

- Founded in 1952 (1997)
- Around 150 employees

Focal points

- Development and manufacture of switchgears for operation and monitoring, safety-related relay modules and controls as well as switchgears for explosion protection

Mühdorf / Inn



Safety Control GmbH

- Founded in 1994 (2008)
- Around 30 employees

Focal points

- Development and manufacture of optical electronic components for safety and automation engineering

Bergisch Gladbach



Böhnke + Partner Steuerungssysteme GmbH

- Founded in 1994 (2012)
- Around 70 employees

Focal points

- Development and manufacture of components, controls and remote diagnostic systems for the lift industry

() = inclusion in the Schmersal Group

2. Schmersal Worldwide

2.3 International Offices

Boituva / Brazil



ACE Schmersal

- Founded in 1974
- Around 350 employees

Focal points

- Manufacture of electromechanical and electronic switchgears
- Customer-specific control systems for the North and South American market

Shanghai / China



Schmersal Industrial Switchgear Co. Ltd

- Founded in 1999
- Around 150 employees

Focal points

- Development and manufacture of switchgears for safety, automation and lift engineering for the Asian market

Ranjangaon / India



Schmersal India Private Limited

- Founded in 2013
- Around 30 employees

Focal points

- Development and manufacture of switchgears for safety, automation and lift engineering for the Indian market

3. Strategic Development

From component manufacturer to industry-oriented solutions provider



Safe solutions for your industry

Following this motto, the Schmersal Group develops and manufactures safety switchgears and switching systems for machine building and plant engineering.

This is how we meet the requirements of an increasingly differentiated market. There are specific risks and specific environmental conditions in key industries using machines and systems such as the food industry, machine tool industry and heavy industry, they set different conditions for machine safety, availability and accessibility.

We have developed precise safety switchgears and solutions for these and other industries. Industry management with appropriate application expertise carries out knowledge transfer from industries to product management and sales.

Please visit our website at www.industry.schmersal.com to learn about our products and solutions. Here you will also find information about the latest technological industry-specific trends, best practice examples and what's being talked about in the industry.

Advice and service of experts

The Schmersal Group is not only a developer and manufacturer of products and system solutions but is also a consultant and service provider. Our certified functional safety engineers offer you qualified support in the configuration of protective gear and the standards-compliant selection of safety switchgear. This also includes support for your designers when making risk assessments pursuant to EN ISO 12100 and EN ISO 14121.

In addition, we work with standardisation committees and co-operate closely with government safety organisations, other institutions and unions for machine and occupational safety. We have initiated the CE network, a union of engineering firms that specialise in various fields of machine safety.

In our tec.nicum in Wuppertal, the new Bietegheim-Bissingen Technology Centre and external locations, we offer you a wide seminar programme on diverse subjects about human and machine safety. Please visit www.tecnicum.schmersal.com for information about our seminar programme.

4. Commitments and Responsibility



Environmental protection worldwide

One of the objectives of the Schmersal Group is to adhere to the principles of a sustainable economy and to consider environmental and social issues as of equal value in conjunction with economic aspirations.

For this reason, over the last two years we have been making the best use of energy generation on our Wuppertal site and, among other things, have commissioned our own combined heat and power unit (CHP), installed a new condensing boiler, and refurbished the air-conditioning and heat recovery systems in the injection moulding station and compressed air station. The result is an annual reduction of CO₂ emissions of the plant by approximately 150 tonnes. The new facilities in China and India were designed based on ambitious energy standards.

Social responsibility

The Schmersal Group takes responsibility as a corporate citizen at all production locations. We sponsor activities, local community initiatives and sports clubs. We are very committed to educational projects for children.

The Schmersal Group offers personnel and their families lasting job security and pays attention to family unity, leisure and occupation. This is evidenced, for example, by the company's own kindergarten in Wuppertal and the many sports activities it carries out on company sites all over.

Beyond its responsibility towards the environment and its employees, the Schmersal Group complies with the Codes of Conduct of the ZVEI and the European Co-ordinating Committee of Manufacturers of Electrical Switchgear and Controlgear (CAPIEL) in corporate governance and in the establishment of business relations. A basic understanding and the recommendations for action of both documents are part of our corporate philosophy.

5. Industrial Solutions

5.1 Food



Industries

Harvesting, drying, filleting, heating, grinding, mixing, bottling and packaging: food production involves a lot of process steps, most of which are run by machines. Not only do machine safety standards and guidelines need to be followed during these processes, safety switchgear or controlgear at the human-machine interface also have to meet strict hygiene requirements. In other areas, a high degree of temperature resistance or resistance to moisture is required. Explosion protection also plays a role in the processing of powdered raw materials or products.

Products

Schmersal, for example, has developed the BNS 40S safety sensors with stainless steel enclosure and under protection class IP69K especially for safety door monitoring on food processing machines. The same applies to the SLC 420 IP69K safety light curtain. Another product group dedicated to food production is the N series of command and signalling devices which meets the requirements of EN 1672-2 (Food processing machinery: Basic concepts - Hygiene requirements) and, in addition, is certified for clean rooms.

Please visit our website www.industry.schmersal.com for more information.

Applications



5. Industrial Solutions

5.2 Packaging



Industries

Machines and systems used in the packaging industry are often operated at high speed and with short cycle times. They are frequently part of the entire production and/or packaging lines. For this reason, guard systems should only interrupt production processes or negatively influence system productivity when absolutely necessary. They must also work with extreme accuracy on a 24/7 basis.

Products

Many safety switchgears from the Schmersal Group - especially those preferred in the packaging machine building industry are designed so that unplanned stoppages of machinery are avoided. Safety switchgears with an integrated AS safety at work interface and our compact safety control PROTECT SELECT are also often used in this industry. New and innovative solenoid interlocks such as the MZM 100 and AZM 300 were also developed with the special needs of the packaging industry in mind.

Please visit our website www.industry.schmersal.com for more information.

Applications



5. Industrial Solutions

5.3 Elevators and Escalators



Industries

The Schmersal Group has a hand in the fact that lifts are the safest transport device in the world. For many decades now we have been one of the world's leading makers of switchgears for lifts and escalators, offering the lift industry a wide range of products. All lift switchgears meet pertinent international requirements and operate fault-free and failproof even under unsuitable conditions.

Products

Our lift switchgears are generally used in the active and passive safety circuit of lift systems, locking and safety monitoring lift doors. The product palette includes floor and fine-adjustment switches, positive-break door contacts, position switches, solenoid switches, emergency call systems as well as the USP non-contact positioning system. We have also developed custom switchgear for special tasks such as the electric shutdown of the lift system upon actuation of the speed limiter. In addition, through the merger of Böhnke & Partner with the Schmersal Group we can offer complete control technology at the highest level of engineering and quality.

Please visit our website www.industry.schmersal.com for more information.

Applications



5. Industrial Solutions

5.4 Heavy industry



Industries

We have more than six decades of experience within the heavy industry, as the Schmersal Group was originally a manufacturer of high-grade switchgear. Today our products are used everywhere where special requirements exist in difficult and harsh operating environments e.g. mining, construction machinery, ship engineering, various types of cranes and hoisting devices as well as power generation.

Products

Many switchgears we have developed for heavy industry, at first glance, differ from other series in the same product group. They are very robust, oftentimes even significantly larger, and are radically designed for high durability even at extreme stresses. This applies, among others, to our heavy position switches, foot switches, heavy-duty command devices, belt alignment switches and pull-wire emergency stop switches.

Applications



5. Industrial Solutions

5.5 Machine tools



Industries

Machines in the metal processing industry operate with extremely high accuracy requirements at ever increasing speeds and need to be as flexible as possible. They may not affect machine productivity or flexibility. In addition, they must be easy to retrofit and must allow quick trouble-shooting. Protection against tampering must always be in the forefront. The Schmersal Group offers a wide product range for the most diverse requirements, covering even special operating modes such as process monitoring and setting mode.

Products

Solenoid interlocks are often used in machine tool building to prevent the interruption of processes or to protect against hazards arising due to overrunning. There is an extensive product portfolio available for the most diverse requirements: for example, safety switchgears for special operating modes such as process monitoring and setting mode.

Please visit our website www.industry.schmersal.com for more information.

Applications

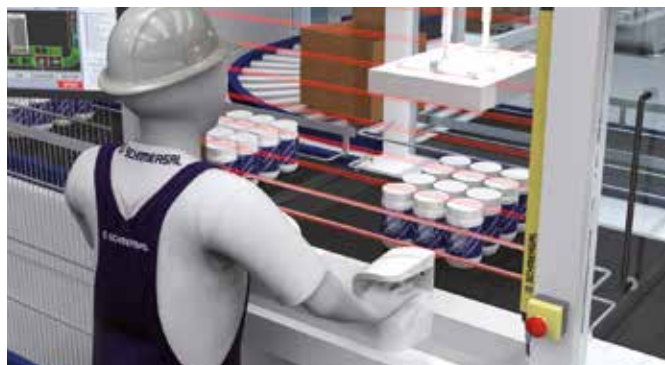

5. Industrial Solutions

5.6 Automobile



Industries

High degree of automation, interruption-free processes, high degree of standardisation, great importance of factory standards: these, in brief, are the key features of automobile manufacturing in terms of machine safety. Another characteristic is the intensive use of robots and interlinked production lines.

Products

Our solenoid interlock programme includes systems that were explicitly developed for accessible hazardous areas and offer numerous additional properties such as an emergency exit with emergency handle. In the control engineering field we have also developed solutions that make it almost impossible for persons to be shut inside a hazardous area. In addition, we have extensive experience in the design of safe robot workstations with or without perimeter guarding.

Applications



6. Services



Expertise based on practical experience for practical application

Firsthand knowledge

Machine safety is an exacting and multilayer subject matter that places machine designers and factory safety engineers before real challenges. Numerous guidelines and standards need to be followed in the selection of protective gear. In many cases one has to deal with complex regulations which require sufficient time and expertise to be understood.

In the complex field of machine safety it is important for designers and safety engineers to stay informed at all times and to obtain firsthand knowledge. In this context, our tec.nicum training centre regularly offers an extensive seminar programme on various subjects concerning, among others; individual standards or product groups or, for example; questions about safe design or ergonomic construction of machines. We also arrange many seminars in our new technology centre in Bietigheim-Bissingen as well as in other locations. Please visit www.tecnicum.schmersal.com for information about our seminar programme.

We also see it as our duty to inform experts constantly about current developments in machine safety using scientific papers, publications, lectures and reference books.



Machine safety in Europe
What's new in machine safety and machine control systems

ISBN No. 978-3-935966-25-2



Giving good advice right from the start

More and more companies want competent support and advice in the implementation of these standards. Support from experts means that you will arrive at your desired goal quicker and safer when you are dealing with particular issues. This was the reason why the Schmersal Group bundles expertise on these types of tasks and to entrust this advisory capacity to particularly trained specialists. These certified functional safety engineers work worldwide in 18 countries. They support designers, for example, in EN ISO 12100:2000 risk assessment as well as in the execution of the CE conformity assessment procedure.

External support from specialists

In Germany our safety consultants collaborate with the CE Network, which means they can rely on comprehensive expert knowledge for special tasks. This network of competent engineering companies, which was initiated by the Schmersal Group, provides mechanical engineers with competent advice on complex subjects regarding machine safety. In the CE network there is a specialist for the most extraordinary problem and an answer for every question. When the decision is made to implement the suggested solutions (for example, to overhaul the safety aspects of a machine), Schmersal can recommend competent partners with all-round experience and a high level of know-how in safety engineering.



www.ce-netzwerk.com

7. Products

7.1 Application Finder



1

Safety guard monitoring

- Safety switches with separate actuator
- Position switches
- Safety switches for hinged guards
- Safety sensors
- Solenoid interlocks



2

Optoelectronic safety devices

- Safety light grid
- Safety light curtains
- Safety light barriers



3

Command devices with safety function

- Pull-wire emergency stop switches
- Safety foot switches
- Emergency stop buttons
- Enabling switches
- Two-hand control panels



4

Safety-related tactile sensors

- Safety mats
- Safety edges
- Safety bumpers



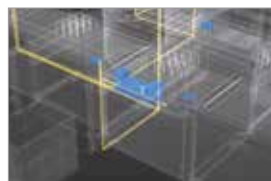
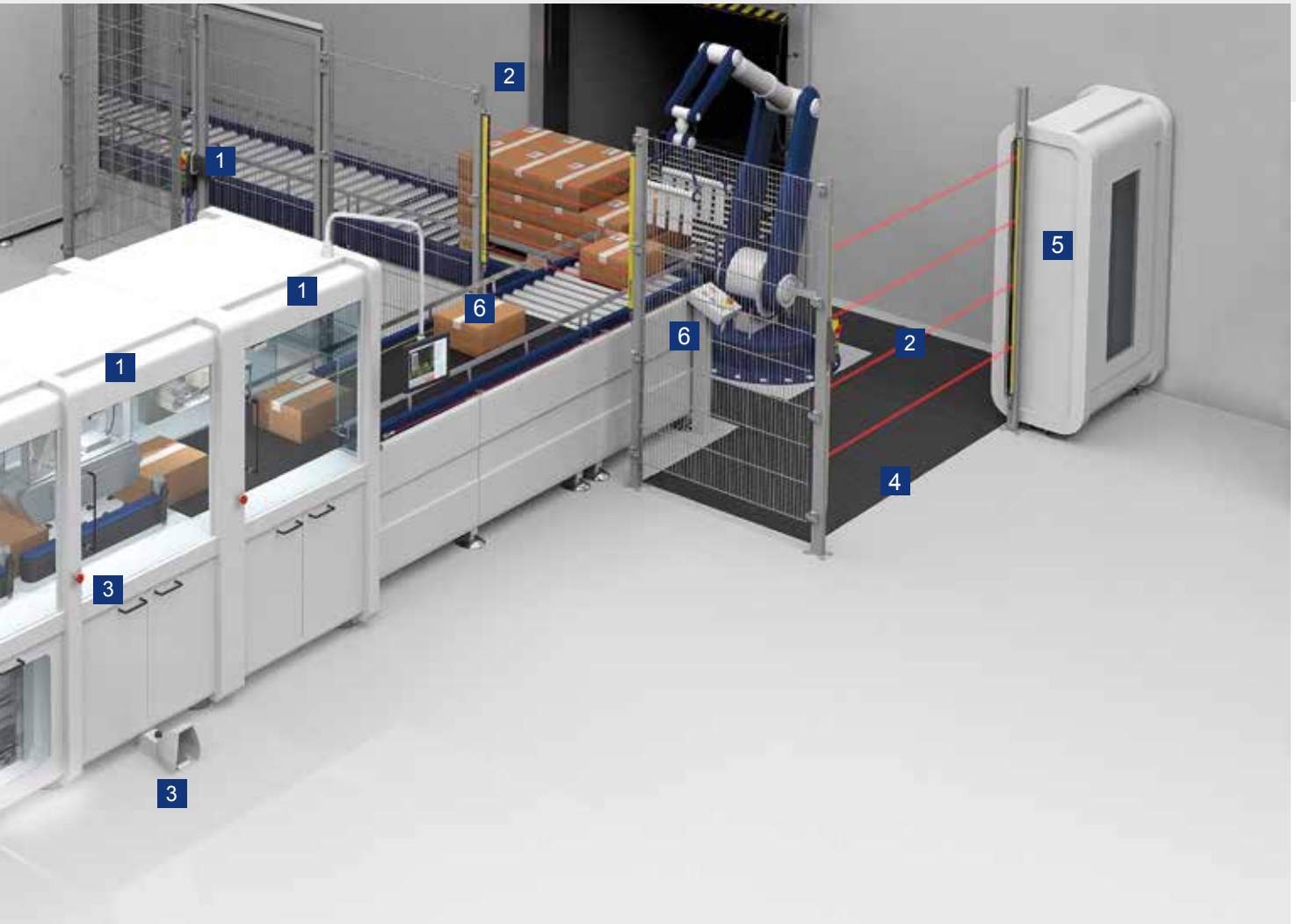

Safe signal processing

- Programmable safety controls
- Compact safety controls
- Safety relay modules
- Output extensions
- Input extensions
- Fail-safe standstill monitors
- Fail-safe delay timer

Command and signalling devices

- Control panels
- Command devices and indicator lights
- LED signal towers CleanSIGN

AS-Interface Safety at Work

- Solenoid interlocks
- Safety sensors
- Safety switches
- Emergency stop and command devices
- Safety monitors
- Master monitor combinations
- Safety gateways
- Installation accessories

Explosion protection switchgear

- Ex-protection solenoid interlocks
- Ex-protection safety switches
- Ex-protection position switches
- Ex-protection safety sensors
- Ex-protection pull-wire emergency stop switches
- Ex-protection command devices and indicator lights
- Ex-protection safety relay modules

7. Products

7.2 Safety door monitoring

The Schmersal Group's extensive product spectrum for monitoring hinged, removable and sliding safety doors allows the guard system of any application to be precisely adjusted to requirements. If special requirements exist e.g. with regard to explosion protection, hygiene, compactness, clamping force, actuation or wiring possibilities, suitable solutions are also available, including for walk-in zones.



Safety switch with separate actuator

Safety switches with separate actuator are suitable for sliding, hinged and, in particular, removable guard systems which need to be closed to guarantee the necessary operational safety. They can also be fitted on profile sections and retrofitted on existing equipment. The Schmersal product spectrum includes the AZ 16 which has been manufactured a million times over and is considered "the" safety switch by many companies.

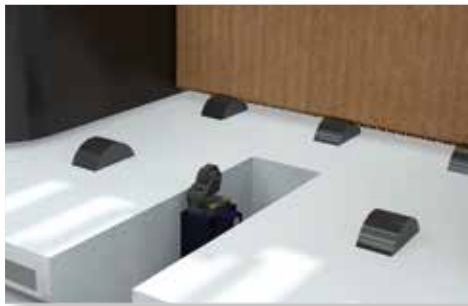

Position switch with safety function

Position switches with safety function are suitable for sliding and rotating protective gear that need to be closed to ensure the necessary operational safety. Through an actuating element (such as a roller lever) they sense the position of the safety door and send a corresponding signal to the safety relay module or to the control.



Safety switches for hinged guards

For hinged safety doors, there's an elegant, space saving and tamper-proof alternative to safety switches with separate actuator and position switches with safety function. Hinge safety switches fixed to the hinge side of the safety door eliminate the need for switches on the door itself and hence keep the operator's work area free of switches. Positive fixing of the hinge switches means they are particularly tamper-proof.



Safety sensors

Typical applications of safety sensors include machines where a high concentration of dust and contamination is expected to appear in hyper-sensitive areas such as food processing machines. Because of their non-contact operation, safety sensors are easy to install since they are more tolerant of misalignments in actuators and sensors. Apart from the classic safety solenoid switches, Schmersal also offers safety sensors with innovative, proprietary operating principles that allow a simplified and safe signal evaluation and the integration of additional functions.



Solenoid interlocks

The solenoid interlocks of the AZM and MZM series ensure that, in conjunction with the control portion of a machine such as fail-safe standstill monitors or delay timers, sliding, hinged and removable protective gear does not open before hazardous conditions (run-on movements) have been eliminated. The Schmersal Group portfolio also offers non-contact solenoid interlocks, integrated solutions with door handle as well as the AZM 300 solenoid interlock with a new and innovative operating principle.



Door handle actuator

There are door handle actuators available for the various series of safety switches and solenoid interlocks, either integrated or as a separate component. This allows the safety and actuation function and, where applicable, the release button to be combined into one ergonomic unit.

7. Products

7.3 Optoelectronic safety devices

The Schmersal Group protective equipment come in two categories: electromechanical protective equipment with physical separation or non-contact protective equipment. The "Center of Competence" for Opto-Electronics in Mühldorf/ Inn designs and manufactures a wide range of optoelectronic components for securing hazards zones and areas. There are many situations in which this type of switchgear offers greater flexibility than conventional electromechanical switchgear.



Safety light curtains

Safety light curtains secure hazard spots and areas in a number of application areas, for example in presses, die casting machines and palletisers. Transmitter and receiver are housed in separate enclosures. The transmitter emits a set of invisible infrared beams thereby creating a protective field. The receiver detects these beams, and if any person or object interrupts them, the transmitter is stopped and the machine is halted.

Safety light curtains are frequently used in automated material handling plants because they allow, for example, the safety functions to be individually adapted to the production processes.



Safety light grids

Just like safety light curtains, safety light grids are frequently found in application areas where materials need to be transported in and out of hazard zones. The safety solution is based on functions such as "muting" and "blanking".

In addition to its standard series, which, among other things, includes compact models and devices with protection class IP69K, Schmersal also designs and manufactures customised optoelectronic guard systems.



Safety light barriers

The SLB series of safety light barriers are used to cordon off hazard zones, for example, in automatic machining centres and on transfer lines and robots. Their compact design means they can be easily integrated into any machine construction.



SLC / SLG 440 safety light curtains and light grids:

- Automatic parameter configuration
- Set-up tool and large status display
- Many extra functions
- Immunity to electromagnetic interference

7. Products

7.4 Command devices with safety function

Schmersal control devices always transmit operator commands safely and reliably, regardless of whether the commands stop hazardous movements or start critical machine functions.

In addition to the various special constructional features, Schmersal instruction devices excel in terms of longevity and ergonomic design.



Pull-wire emergency-stop switches

For machine parts which can't be protected using safety covers, pull-wire Emergency-Stop switches with their "extended arm" offer an excellent alternative to Emergency-Stop buttons. The advantage of pull-wire switches over mushroom head Emergency-Stop push buttons is that the Emergency-Stop command can be triggered anywhere along the wire.



Safety foot switches

Safety foot switches are used as enabling devices for machines and systems where, for example, manual operation is not possible. The main application areas are machines in the metal working industry.



Emergency-Stop button

These command and signalling devices are very important for man-machine interfaces in industrial applications. They are typically used in control cabinets, control panels, two-hand control panels, elevator construction or conveyor and material handling plants. When manually triggered, the devices initiate the switching off procedure.



Enabling switches

Enabling switches are used - perhaps together with other safety measures to provide personal protection in potentially hazardous environments where the special operating modes of a machine necessitate partial or complete removal of the safety guards. The current Machinery Directive (2006/42/EC) as well as diverse product-specific EC standards specially underline how machine operation can be simplified.

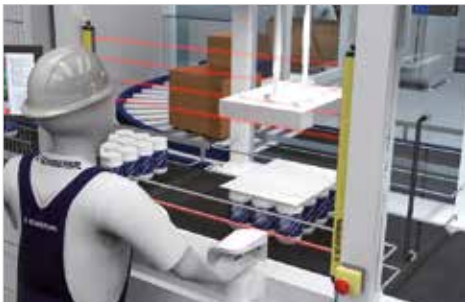

Two-hand control panels

Two-hand control panels belong to the family of non-separating protective equipment. In general, they serve to ensure the machine operator's hands are located on the control panel when the control signal for a hazardous movement is issued. These command devices thus ensure the operator is not in the way of dangerous moving parts when a machine or plant is started.

7. Products

7.5 Safety-related tactile sensors



Wherever there is a risk of injury from crushing or shearing, such as with elevating platforms, rising stages, sliding doors or industrial gates, tactile safety devices provide a simple and easy to fit solution. Two dimensional safety sensors are often needed in the hazardous area to monitor, for example, industrial robots, or punching, bending and woodworking machines.

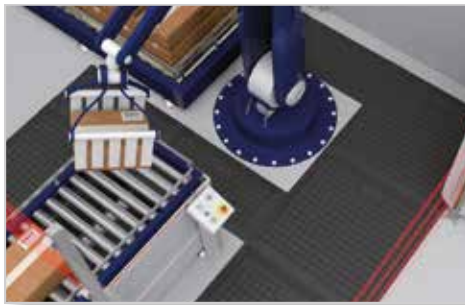

Safety mats

Safety switch mats can be used in hazardous zones with clearly defined boundaries as an alternative to other constructional types of protective switchgear. Entry of the operator into the active area triggers a safety signal which brings the machine or plant to a standstill.



Safety edges

If there is a risk of crushing or piercing from automatically moving machine or machine parts, these areas can be secured using safety edges, for example, on lift tables, lifting platforms, or the lift gates of automated production plants, driverless transportation systems (DTS) and mobile shelving systems.



Safety bumpers

Safety-related bumpers trigger switch-off as soon as they become deformed by a hazardous movement. They offer protection from the risk of crushing and piercing. In direct comparison with safety edges, they have a greater deformation area. The shape of the bumper can be adjusted to requirements.

7. Products

7.6 Safe signal processing



Besides the traditional safety-monitoring modules, the Schmersal Group product range also includes diverse microprocessor based safety devices. Depending on the complexity and number of safety circuits, integral solutions with safety monitoring modules and control units, and featuring many visualisation and diagnostic possibilities are available.



Safety-monitoring modules

The AES and SRB range of safety-monitoring modules features the greatest diversity of design and functionality. All modules correctly evaluate switching commands. Besides the standard devices which integrate Emergency-Stop buttons and solenoid interlocks into safety circuits, the product range also includes fail-safe standstill monitors and time relays. Specialist solutions have been developed for specific problem areas, for example, a safety-monitoring module with double acknowledgement is available for hazardous walk-in zones.

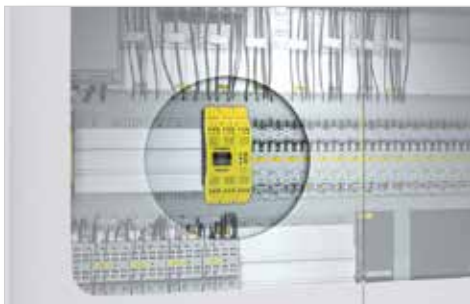

Compact safety controller

With the PROTECT SELECT compact safety controller, the engineer has greater flexibility during configuration of the safety device and its subsequent integration into the machine functions. There are four basic product ranges. The products of all ranges can be adapted in the finest detail to the specific application via a clear menu-guided program with human-readable information. No programming knowledge is required. The release delay and debounce times can be individually set, and various parameters such as short circuit monitoring can be configured according to requirements. PROTECT SELECT saves space in the switch cabinet as soon as it replaces more than three conventional safety-monitoring modules.



Programmable safety controls

The programmable PROTECT PSC modular safety control system is primarily used in modern production systems or in complex individual machines. Its modular design means the system can be economically adapted or scaled to any task – from eight inputs and six outputs in the most basic version to more than 250 inputs and outputs at the top of the range.

7. Products

7.7 AS-Interface Safety at Work



AS-Interface Safety at Work (AS-i Safety) is a safe bus system designed in accordance with the open AS International standard. Safety components such as Emergency-Stop buttons, safety switches, solenoid interlocks and safety light curtains are connected via the unshielded 2-wire line of the AS interface which also supplies the components with energy.

The safety components transmitted information via the AS-Interface network which is monitored by a safety monitor. If a safety circuit is triggered or a safety component fails, the safety monitor puts the machine or installation safely into a hold position.

Simplified and fail-safe installation

Safety circuits with AS-i SaW communication benefit from, among other things, straightforward installation and commissioning. It's impossible to make a mistake during wiring as the amount of wiring required is minimal. The safety function parameters are easily configured via the ASIMON drag & drop software. Furthermore, additional diagnostic information is available to help eliminate faults quickly.

Broad range of devices with integrated interface

Many companies around the world are enjoying the benefits of AS-i Safety. This safety-relevant communications standard is particularly prevalent in sectors where Schmersal is widely present, for example, in the packaging machinery industry. As a driving force behind the implementation of this standard, Schmersal has equipped all its major safety switchgear product ranges with AS-i safety interfaces. These include:

- Safety switches
- Solenoid interlocks
- Safety sensors
- Safety light curtains
- Emergency-Stop buttons
- Control panels
- Pull-wire emergency stop switches
- Safety foot switches



If the desired safety switchgear is not available with AS-i safety nodes, it can still be integrated into the AS-i safety network by simply using an external input module.



Safety with system: that neatly sums up the basic idea behind the Schmersal system of safety switchgear with integrated AS-i safety interface. Devices are connected in master-monitor combination or via safety gateway modules, and can process up to 60 safe, two channel input and output signals. The status and diagnostic signals can be evaluated by higher-level control systems and from there on transmitted to control or visualisation systems. There are two basic concepts available to the user.

Safety Separated

Even though the operation of PLC-based systems can vary greatly, most mechanical engineers want to use a uniformly designed safety circuit. They therefore prefer a safety control system which is physically separate to the normal control system. For this so-called "Safety Separated" concept, Schmersal system offers master-monitor combinations with different field bus interfaces. The entire safety logic is programmed in the safety monitors using the ASIMON software.

Through the conventional field bus interfaces PROFIBUS, PROFINET, EtherNet/IP or ModbusTCP, the master-monitor combinations with the normal PLC to transmit the non-safety-related status and diagnostic signals. The entire integration of the safety control system simplifies the diagnostics and reduces the standstill times in case of failures.

... or Safety Integrated?

The Schmersal System also includes Safety Gateways, which can be directly connected to safety control systems with safe field bus. They are designed for two AS-i circuits and transmit up to 60 safe inputs/outputs to the safety control system through a safe field bus. The operational, diagnostic-relevant signals are also transmitted to the higher-level control system, where they can be accordingly processed. A pre-processing of the safe signals in the Safety Gateway is also enabled through the ASIMON Software.

A complete product portfolio including consulting

With the Schmersal System, the machine builder has complete solutions for machinery safety from a single source. For both concepts - either Safety Separated or Safety Integrated - multiple master-monitor combinations or Safety Gateways for the commonly used field bus systems are available.

At field level the user has access to a wide range of fail-safe switchgear with integrated ASi safety interface. The Schmersal system also encompasses other monitoring modules, such as safe speed monitoring, safe input and output modules, repeaters as well as a comprehensive range of accessories (bus distributors, power supply units, bus cables, M12 connecting cables...). The complete solution includes consultancy from Schmersal application engineers during system design, and support during commissioning.

7. Products

7.8 Position and limit switches, sensors



For work process automation in both industrial plants and mobile machinery, the Schmersal Group has a full spectrum of position and limit switches ranging in size from big to small. The product range starts with microswitches for mechanical engineering projects. Long-life standard switches are universally deployed in a wide variety of machines. Application areas for gear switches are as diverse as stage engineering and lifting equipment. The product portfolio also covers robust switchgear for operation in the rough ambient conditions typical of heavy engineering industries such as the materials handling, mining and steel industries.

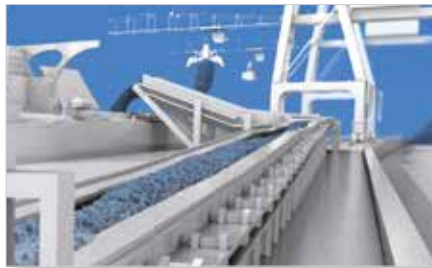

During the 1970's, Schmersal had begun work on a range of non-contact switchgear, and was soon a pioneer in the development and manufacture of inductive proximity switches. Today's products for the automation industry include, among others, magnetic reed switches for the materials handling and lift switchgear industries. Robotics and automated production lines are just two areas where the IFL range of inductive proximity switches are deployed. Besides the standard versions, customised variants compliant with special requirements such as high operating temperatures or sector-specific approvals (e.g. Germanischer Lloyd) are also available.

A variety of sensors for safety-relevant applications are also available.

7. Products

7.9 Switchgear for explosion protection



Explosion protection regulations exist in many industries besides the chemical industry, for example, in the food production industry which processes, manufactures and stores powdered basic substances and end products.

For this area of special responsibility, the Schmersal Group has formed its own competence centre which, over the last few decades, has gathered valuable experience in the development and production of (safety) switchgear compliant with explosion protection regulations.

Machine and plant engineers have access to an extensive range of products encompassing, among other things, a variety of safety switches, position switches and solenoid interlocks. Machines and plants in these sensitive application areas frequently use non-contact safety sensors, and particularly in heavy duty applications, the ex-versions of pull-wire emergency stop switches and belt alignment switches.

The product portfolio continues to grow. Besides field switchgear the portfolio also covers a wide range of safety-monitoring modules for signal evaluation. This makes Schmersal a complete systems solution provider for machine safety, in accordance with its motto "safety in system".

Ex-switchgear is designed in compliance with ATEX 9/49/EC and, depending on the product range, is suitable for ex-zone 1 or 2 (gas-ex), and 21 or 22 (dust-ex).

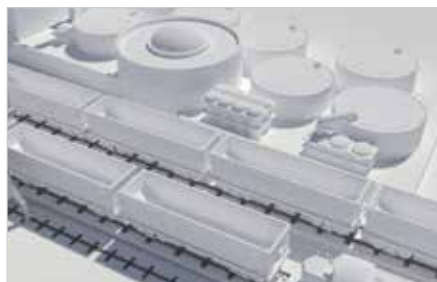

7. Products

7.10 Command and signalling devices

Ergonomic operation of the main machine functions at the man-machine interface is a key factor in safety. For this reason, the Schmersal Group has added its own manufactured command and signalling devices to its product portfolio. These devices provide for transparency by transmitting relevant information to the operator, and allowing the machine to be operated while the work process are observed, even in adverse ambient conditions.



Control panels

BDF products are enclosed in a high quality slimline housing made from shock-resistant plastic and are easily attached to the machine's commercially available aluminium profile system, with space for up to four operating controls. The user can choose from a large product portfolio of illuminated control push buttons, selector switches, LED illuminated indicators, key-operated switches and standard-compliant Emergency-Stop command devices.



The control panel of the BDF product range

- Ergonomic design
- Slimline shock-resistant housing
- Simple mounting on commercially available profile systems
- Variable configuration using command devices and indicator lights

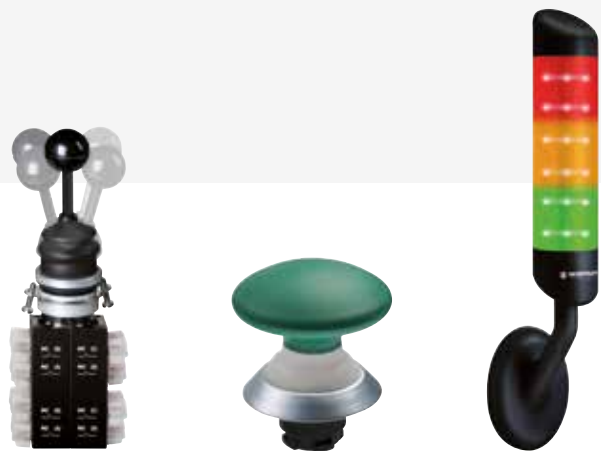

Control devices and indicator lights

The user has the choice of several product series suitable for use, for example, in hygiene-sensitive application areas such as the food industry (N range) or in especially rugged environments (R range). Each range encompasses a diversity of button types and indicator lights.



LED Signal Tower CleanSIGN

The CleanSIGN LED signal tower is state-of-the-art. Its use of modern electronics enables a completely modular approach to the design of the individual stages. Its easy-to-clean and hygienic form means cleansing and disinfection couldn't be simpler, making it suitable for use in the sensitive areas of the food production industry.

■ **Hauptsitz - Headquarters**
K.A. Schmersal GmbH & Co. KG
Industrielle Sicherheitssysteme
 Postfach 24 02 63,
 42232 Wuppertal
 Möddinghofe 30
 D-42279 Wuppertal
 Phone: +49-(0) 2 02-64 74-0
 Fax: +49-(0) 2 02-64 74-1 00
 info@schmersal.com
 www.schmersal.com

Germany - Northern region

■ **Wettenberg**
K.A. Schmersal GmbH & Co. KG
Regionalbüro Nord
 Im Ostpark 2
 D-35435 Wettenberg
 Phone: +49-(0) 6 41-98 48-5 75
 Fax: +49-(0) 6 41-98 48-5 77
 rbnord@schmersal.com

■ **Hamburg / Münster**
K.A. Schmersal GmbH & Co. KG
Vertriebsbüro Hamburg
 Innungsstraße 3
 D-21244 Buchholz i.d.N.
 Phone: +49-(0) 41 81-9 22 0-0
 Fax: +49-(0) 41 81-9 22 0-20
 vbhamburg@schmersal.com

■ **Berlin**
KSA Komponenten der Steuerungs- und Automatisierungstechnik GmbH
 Pankstr. 8-10 / Aufg. L
 D-13127 Berlin
 Phone: +49-(0) 30-47 48 24 00
 Fax: +49-(0) 30-47 48 24 05
 info@ksa-gmbh.de
 www.ksa-gmbh.de

■ **Hannover**
ELTOP GmbH
 Robert-Bosch-Str. 8
 D-30989 Gehrden
 Phone: +49-(0) 51 08-92 73 20
 Fax: +49-(0) 51 08-92 73 21
 eltop@eltop.de
 www.eltop.de

■ **Köln**
Stollenwerk
Technisches Büro GmbH
 Scheuermühlenstr. 40
 D-51147 Köln
 Phone: +49-(0) 22 03-9 66 20-0
 Fax: +49-(0) 22 03-9 66 20-30
 info@stollenwerk.de
 www.stollenwerk.de

■ **Siegen**
Siegfried Klein
Elektro-Industrie-Vertretungen
 In der Steinwiese 46
 D-57074 Siegen
 Phone: +49-(0) 2 71-67 78
 Fax: +49-(0) 2 71-67 70
 info@sk-elektrotechnik.de
 www.sk-elektrotechnik.de

■ **Leipzig**
K.A. Schmersal GmbH & Co. KG
Vertriebsbüro Leipzig
 Servicepark
 Druckereistraße 4
 D-04159 Leipzig
 Phone: +49-(0) 3 41-4 87 34 50
 Fax: +49-(0) 3 41-4 87 34 51
 vbleipzig@schmersal.com

Germany - Southern region

■ **Nürnberg**
K.A. Schmersal GmbH & Co. KG
Regionalbüro Süd
 Lechstraße 21
 D-90451 Nürnberg
 Phone: +49-(0)9 11- 6 49 60 53
 Fax: +49-(0)9 11-63 29 07 29
 rbsued@schmersal.com

■ **Saarland**
Herbert Neundörfer Werks-vertretungen GmbH & Co. KG
 Am Campus 5
 D-66287 Göttelborn
 Phone: +49-(0) 68 25-95 45-0
 Fax: +49-(0) 68 25-95 45-99
 info@herbert-neundoerfer.de
 www.herbert-neundoerfer.de

■ **Bayern Süd**
INGAM Ing. Adolf Müller GmbH
Industrievertretungen
 Elly-Staegmeyr-Str. 15
 D-80999 München
 Phone: +49-(0) 89-8 12 60 44
 Fax: +49-(0) 89-8 12 69 25
 info@ingam.de
 www.ingam.de

■ **Bietigheim**
K.A. Schmersal GmbH & Co. KG
Technologiezentrum
 Pleidelsheimer Straße 15
 74321 Bietigheim-Bissingen
 Phone: +49-(0) 71 42-9 19 80 53
 Fax: +49-(0) 71 42-9 13 45 94
 tzbw@schmersal.com

Europe

■ **Austria - Österreich**
AVS-Schmersal Vertriebs Ges. m.b.H.
 Biróstraße 17
 1232 Wien
 Phone: +43-(0) 1-6 10 28
 Fax: +43-(0) 1-6 10 28-1 30
 info@avs-schmersal.at
 www.avs-schmersal.at

■ **Belgium - Belgien**
Schmersal Belgium NV/SA
 Nieuwlandlaan 16B
 Industriezone B413
 3200 Aarschot
 Phone: +32-(0) 16-57 16 18
 Fax: +32-(0) 16-57 16 20
 info@schmersal.be
 www.schmersal.be

■ **Bulgaria - Bulgarien**
CDL Sensorik OOD
 Stefan Caragea Street
 No 10 Office 4
 7002 Ruse City
 Phone: +359-(0)0 40-7 35 16 55 25
 Fax: +359-(0)0 40-2 69 25 33 44
 office@cdlsensorik.com
 www.cdlsensorik.com

■ **Croatia - Kroatien**
Tipteh Zagreb d.o.o.
 Pescanska 170
 10000 Zagreb
 Phone: +385-1-3 81 65 74
 Fax: +385-1-3 81 65 77
 tipteh.zagreb@zg.t-com.hr

■ **Czech Republic - Tschech. Republik**
Mercom Componenta spol. s.r.o.
 Bechyňská 640
 199 21 Praha 9 - Letňany
 Czech Republic
 Phone: +4 20-(0) 2-67 31 46 40
 Fax: +4 20-(0) 2-71 73 32 11
 mercom@mercom.cz

■ **Denmark - Dänemark**
Schmersal Danmark A/S
 Lautruphøj 1-3
 2750 Ballerup
 Phone: +45-70 20 90 27
 Fax: +45-70 20 90 37
 info@schmersal.dk
 www.schmersal.dk

■ **Finland - Finnland**
Advantec Oy
 Äyritie 12 B
 01510 Vantaa
 Phone: +3 58-2 07 19 94 30
 Fax: +3 58-9 35 05 26 60
 advantec@advantec.fi
 www.advantec.fi

■ **France - Frankreich**
Schmersal France
 BP 18 - 38181 Seyssins Cedex
 8, rue Raoul Follereau
 38180 Seyssins
 Phone: +33-4 76 84 23 20
 Fax: +33-4 76 48 34 22
 info-fr@schmersal.com
 www.schmersal.fr

■ **Greece - Griechenland**
Kalamarakis Sapounas S.A.
Ionias & Neromilou
 PO Box 46566
 13671 Chamomilos Acharnes
 Athens
 Phone: +30-(0) 210-2 40 60 00-6
 Fax: +30-(0) 210-2 40 60 07
 ksa@ksa.gr

■ **Hungary - Ungarn**
NTK Ipari-Elektronikai és Kereskedelmi Kft
 Mészáros L. u. 5.
 9023 Győr
 Phone: +36-(0) 96-52 32 68
 Fax: +36-(0) 96-43 00 11
 info@ntk-kft.hu
 www.ntk-kft.hu

■ **Iceland - Island**
Reykjafell Ltd.
 Skipholt 35
 125 Reykjavik
 Phone: +354-5 88 60 10
 Fax: +354-5 88 60 88
 reykjafell@reykjafell.is

■ **Italy - Italien**
Schmersal Italia s.r.l.
 Via Molino Vecchio, 206
 25010 Borgosatollo, Brescia
 Phone: +39-0 30-2 50 74 11
 Fax: +39-0 30-2 50 74 31
 info@schmersal.it
 www.schmersal.it

■ **Macedonia - Mazedonien**
Tipteh d.o.o. Skopje
 Ul. Jani Lukrovski br. 2/33
 1000 Skopje
 Phone: +389-70-39 94 74
 Fax: +389-23-17 41 97
 tipteh@on.net.mk

■ **Netherlands - Niederlande**
Schmersal Nederland B.V.
 Lorentzstraat 31
 3846 AV Harderwijk
 Phone: +31 (0)3 41-43 25 25
 Fax: +31 (0)3 41-42 52 57
 info-nl@schmersal.com
 www.schmersal.nl

■ **Norway - Norwegen**
Schmersal Norge
 Hoffsvæien 92
 0377 Oslo
 Phone: +47-22 06 00 70
 Fax: +47-22 06 00 80
 info-no@schmersal.com
 www.schmersal.no

■ **Poland - Polen**
Schmersal - Polska Sp.j.
 ul. Baletowa 29
 02-867 Warszawa
 Phone: +48-(0) 22-8 16 85 78
 Fax: +48-(0) 22-8 16 85 80
 info@schmersal.pl
 www.schmersal.pl

■ **Portugal - Portugal**
Schmersal Ibérica, S.L.
 Apartado 30
 2626-909 Póvoa de Sta. Iria
 Phone: +351 - 21 959 38 35
 Fax: +34 - 93 396 97 50
 info-pt@schmersal.com
 www.schmersal.pt

■ **Romania - Rumänien**
CD SENSORIC SRL
 Str. George Enescu 21
 550248 Sibiu
 Phone: +40-(0)2 69-25 33 33
 Fax: +40-(0)2 69-25 33 44
 proiecte@cdl.ro
 www.cdl.ro

■ **Russia - Russland**
OOO AT electro Moskau
 ul. Avtosavodskaya 16-2
 109280 Moskau
 Phone: +7-(0) 49 5-9 21 44 25
 Fax: +7-(0) 49 5-9 26 46 45
 info@at-e.ru
 www.at-e.ru

■ **OOO AT electro Petersburg**
 Polytechniskaya str, d.9,B
 194021 St. Petersburg
 Phone: +7-(0) 81 2-7 03 08 17
 Fax: +7-(0) 81 2-7 03 08 34
 spb@at-e.ru

■ **AT-Electronics Ekaterinburg**
 Bebelaya str. 17, room 405
 620034 Ekaterinburg
 Phone: +7-(0) 34 3-2 45 22 24
 Fax: +7-(0) 34 3-2 45 98 22
 ural@at-e.ru

■ **Slovakia - Slowakei**
Mercom Componenta s.r.o.
 Bechyňská 640
 199 21 Praha 9 - Letňany
 Czech Republic
 Phone: +4 20-(0) 2-67 31 46 40
 Fax: +4 20-(0) 2-71 73 32 11
 mercom@mercom.cz

■ **Slovenia - Slowenien**
Tipteh d.o.o.
 Ulica Ivana Roba 21
 1000 Ljubljana
 Phone: +386-1-2 00 51 50
 Fax: +386-1-2 00 51 51
 info@tipteh.si

■ **Spain - Spanien**
Schmersal Ibérica, S.L.
Pol. Ind. La Masía
 Camí de les Cabòries, Nave 4
 08798 Sant Cugat Sesgarrigues
 Phone: +34 - 93 897 09 06
 Fax: +34 - 93 396 97 50
 info-es@schmersal.com
 www.schmersal.es

■ **Sweden - Schweden**
Schmersal Nordiska AB
 Klockarns Väg 1
 43533 Mölnlycke
 Phone: +46-(0) 31-3 38 35 00
 Fax: +46-(0) 31-3 38 35 35
 solsten@schmersal.se
 www.schmersal.se

- Switzerland - Schweiz**
Schmersal Schweiz AG
 Moosmattstraße 3
 8905 Arni
 Phone: +41-(0) 43-3 11 22 33
 Fax: +41-(0) 43-3 11 22 44
 info-ch@schmersal.com
 www.schmersal.ch
- Turkey - Türkei**
BETA Elektrik Sanayi ve Ticaret Dogan Bektas Okçumusa Caddesi
 Anten Han No. 16/A
 34420 Karaköy / Istanbul
 Phone: +90-212-235 99 14
 Fax: +90-212-253 54 56
 info@betaelektrik.com
 www.betaelektrik.com
- UK - Großbritannien**
Schmersal Ltd.
Sparrowhawk Close
Unit 1, Beauchamp Business Centre
Enigma Park
 Worcs WR14 1GL, Malvern
 Phone: +44-(0) 16 84-57 19 80
 Fax: +44-(0) 16 84-56 02 73
 support@schmersal.co.uk
 www.schmersal.co.uk
- Ukraine - Ukraine**
INCOMTECH-PROJECT Ltd
 17-25, Hertsena St., of. 9
 04050 Kyiv Ukraine
 Phone: +38 044 486 2537
 www.i-p.com.ua/
- VBR Ltd.**
 41, Demiyivska Str.
 03040 Kyiv Ukraine
 Phone: +38 (044) 259 09 55
 Fax: +38 (044) 259 09 55
 office@vbr.com.ua
 www.vbr.com.ua/about_en.htm
- Brazil - Brasilien**
ACE Schmersal
Eletroeletrônica Industrial LTDA
 Rodovia Boituva - Porto Feliz, KM 12
 Jardim Esplanada - ZIP 18550-000,
 Boituva, SP
 Phone: +55-(0) 15-32 63-98 00
 Fax: +55-(0) 15-32 63-98 99
 export@schmersal.com.br
 www.schmersal.com.br
- Canada - Kanada**
Schmersal Canada LTD.
 15 Regan Road Unit #3
 Brampton, Ontario L7A 1E3
 Phone: (905) 495-7540
 Fax: (905) 495-7543
 infocanada@schmersal.com
 www.schmersalcanada.com
- Chile - Chile**
Vitel S.A.
 Chiloe 1189, Casilla 440-3
 Santiago
 Phone: +56 (2) 5 56 26 46
 Fax: +56 (2) 5 55 57 90
 francisco@vitel.cl
 www.vitel.cl
- PR China - VR China**
Schmersal Industrial
Switchgear Co. Ltd.
 Wai Qing Song Road 5388
 201700 Shanghai / Qingpu
 Phone: +86-21-63 75 82 87
 Fax: +86-21-63 75 82 97
 sales@schmersal.com.cn
 www.schmersal.com.cn
- Colombia - Kolumbien**
Cimpex Ltda.
 Calle 53 # 45-112 Of. 1401
 Ed. Colseguros
 Medellin-Antioquia
 Phone: +57 4 512 05 80
 Fax: +57 4 251 46 08
 cimpexjo@une.net.co
- Costa Rica - Costa Rica**
Euro-Automation-Tec, S.A.
 Apartado 461 - 1200 Pavas
 1000 - San José
 Tel/Fax: +5 06-22 35-60 85
 eurotec.jhtg@yahoo.de
- Honduras - Honduras**
Lusitana Intl - Honduras
 2 calle entre 8 y 9 avenida N.O.
 Barrio la Primavera
 Choloma
 Phone: +5 (04) 61 7 - 04 55
 Mobil: +5 (04) 33 96 22 90
 jaimefernandes2002@yahoo.com
- India - Indien**
Schmersal India Private Limited
 Plot No G 7/1,
 Ranjangaon MIDC,
 Taluka Shirur,
 District Pune 412220, India
 Telephone: +91 20 66861100
 Fax: +91 20 66861114
 info-in@schmersal.com
 www.schmersal.in
- Indonesia - Indonesien**
PT. Wiguna Sarana Sejahtera
 Jl. Daan Mogot Raya No. 47
 Jakarta Barat 11470
 Phone: +62-(0) 21-5 63 77 70-2
 Fax: +62-(0) 21-5 66 69 79
 email@ptwiguna.com
 www.ptwiguna.com
- Israel - Israel**
A.U. Shay Ltd.
 23 Imber St. Kiriat Arie.
 P.O. Box 10049
 Petach Tikva
 Phone: +9 72-3-9 23 36 01
 Fax: +9 72-3-9 23 46 01
 shay@uriel-shay.com
- Japan - Japan**
Schmersal Japan Branch Office
 3-39-8 Shoan, Sugunami-ku
 Tokyo 167-0054
 Phone: +81-3-3247-0519
 Fax: +81-3-3247-0537
 safety@schmersal.jp
 www.schmersal.jp.com
- Korea - Korea**
Mahani Electric Co. Ltd.
 792-7 Yeoksam-Dong, Kangnam-Gu
 135-080 Seoul
 Phone: +82-(0) 2-21 94-33 00
 Fax: +82-(0) 2-21 94-33 97
 yskim@mec.co.kr
 www.mec.co.kr
- LITAUEN/ESTLAND/LETTLAND**
BOPLALIT
 Mus galite rasti:
 Baltu pr. 145, LT-47125, Kaunas
 Phone: +370 37 298989
 Phone: +370 37 406718
 infoboplalit.lt
 www.boplalit.lt
- Malaysia - Malaysien**
Ingermark (M) SDN.BHD
 No. 29, Jalan KPK 1/8
 Kawasan Perindustrian Kundang
 48020 Rawang, Selangor Darul Ehsan
 Phone: +6 03-60-34 27 88
 Fax: +6 03-60-34 21 88
 enquiry@ingermark.com
- Mexico - Mexiko**
ISEL SA de CV
 Via Lopes Mateos
 128. Col Jacarandas
 54050 Tlalnepantla Edo. de Mexico
 Phone: +52 (55) 53 98 80 88
 Fax: +52 (55) 53 79 39 85
 mario.c@isel.com.mx
 www.isel.com.mx
- New Zealand - Neuseeland**
Hamer Automation
 85A Falsgrave Street
 Philipstown
 Christchurch, New Zealand
 Phone: +64 (0)33 66 24 83
 Fax: +64 (0)33 79 13 79
 sales@hamer.co.nz
 www.hamer.co.nz
- Pakistan - Pakistan**
eurotech JLT
 Office No.3404, 34th Floor,
 HDS Tower, Sheikh Zayed Road,
 Jumeirah Lakes Towers (JLT),
 P.O.Box 643650,
 Dubai, UAE
 Phone: +9 71-4-4 21 46 00
 Fax: +9 71-4-4 21 46 01
 sales@eurotech.ae
 www.eurotech.ae
- Paraguay - Paraguay**
All-Med
Importación - Exportación -
Representaciones
 Tacuary No. 1318e / 1 ra. Y 2da.
 Asunción
 Phone: +595 (21) 37 04 40
 Fax: +595 (21) 37 16 87
 allmed@telesurf.com.py
- Peru - Peru**
Fametal S.A.
 Av. Republica de Panamá 3972
 Surquillo Lima
 Phone: +511 44 11 100 / 44 10 105
 Fax: +511 42 25 120
 fametal@fametal.com
 www.fametal.com
- Serbia/Montenegro -**
Serbien/Montenegro
Tipteh d.o.o.
 Toplice Milana 14A
 11050 Belgrade
 Phone: +3 81-(0)11-2 89 22 50
 Fax: +3 81-(0)11-3 01 83 26
 www.tipteh.rs
- Singapore - Singapur**
Tong Sim Marine & Electric Co.
 46 Kaki Bukit Crescent
 Kaki Bukit Techpark 1
 Singapore 416269
 Phone: +65-67 43 31 77
 Fax: +65-67 45 37 00
 tongsim@singnet.com.sg
 www.tongsim.com
- South Africa - Südafrika**
A+A Dynamic Distributors (Pty) Ltd.
 20 - 24 Augusta Road
 Regents Park
 2197 Booysens
 Phone: +27-11-6 81 59 00
 Fax: +27-11-4 35 13 18
 awkayser@iafrica.com
- Taiwan - Taiwan**
Golden Leader Camel Ent. Co., Ltd.
 No. 453-7, Pei Tun Rd.
 Taichung, Taiwan
 Phone: +886-4-22 41 29 89
 Fax: +886-4-22 41 29 23
 camel88@ms46.hinet.net
 www.leadercamel.com.tw
- Thailand - Thailand**
M. F. P. Engineering Co. Ltd.
 64-66 Buranasart Road
 Sanchaoporsva
 Bangkok 10200
 Phone: +66-2-2 26 44 00
 Fax: +66-2-2 25 67 68
 info@mfpthai.com
 www.mfpthai.com
- United Arab Emirates -**
Vereinigte Arabische Emirate
eurotech JLT
 Office No.3404, 34th Floor,
 HDS Tower, Sheikh Zayed Road,
 Jumeirah Lakes Towers (JLT),
 P.O.Box 643650,
 Dubai, UAE
 Phone: +9 71-4-4 21 46 00
 Fax: +9 71-4-4 21 46 01
 sales@eurotech.ae
 www.eurotech.ae
- USA - USA**
Schmersal Inc.
 660 White Plains Road, Suite 160
 Tarrytown, NY 10591-9994
 Phone: +1-(0) 9 14-3 47-47 75
 Fax: +1-(0) 9 14-3 47-15 67
 infousa@schmersal.com
 www.schmersalusa.com
- Uruguay - Uruguay**
Gliston S.A.
 Pedernal 1896 - Of. 203
 CP 11800 Montevideo
 Phone: +598 (2) 2 00 07 91
 Fax: +598 (2) 2 00 07 91
 colmedo@gliston.com.uy
 www.gliston.com.uy
- Venezuela - Venezuela**
EMI Equipos y Sistemas C.A.
 Calle 10, Edf. Centro Industrial
 Martinisni, Piso 3, La Urbina
 Caracas
 Phone: +58 (212) 2 43 50 72
 Fax: +58 (212) 2 43 50 72
 jpereira@emi-ve.com



The Schmersal Group

For many years the privately owned Schmersal Group has been developing and manufacturing products to enhance occupational safety. What started out with the development and manufacture of a very wide variety of mechanical and non-contact switchgear has now become the world's largest range of safety systems and solutions for the protection of man and machine. Over 1,500 employees in more than 50 countries around the world are developing safety technology solutions in close cooperation with our customers, thus contributing to a safer world.

Motivated by the vision of a safe working environment, the Schmersal Group's engineers are constantly working on the development of new devices and systems for every imaginable application and requirement of the different industries. New safety concepts require new solutions and it is necessary to integrate new detection principles and to discover new paths for the transmission and evaluation of the information provided by these principles. Furthermore, the set of ever more complex standards, regulations and directives relating to machinery safety also requires a change in thinking from the manufacturers and users of machines.

These are the challenges which the Schmersal Group, in partnership with machinery manufacturers, is tackling and will continue to tackle in the future.

Product ranges



Safe switching and monitoring

- Guard door monitoring safety switches
- Command devices with safety function
- Tactile safety devices
- Optoelectronic safety devices

Safe signal processing

- Safety monitoring modules
- Safety controllers
- Safety bus systems

Automation

- Position detection
- Command and signalling devices

Industries



- Elevators and escalators
- Packaging
- Food
- Machine tools
- Heavy industry

Services



- Application advice
- CE conformity assessment
- Risk assessment in accordance with the Machinery Directive
- Stop time measurements
- Training courses

Competences



- Machine safety
- Automation
- Explosion protection
- Hygienic design

Precautions have been taken to assure accuracy of the information in this catalogue. Typographic or pictorial errors that are brought to our attention will be corrected in subsequent issues.

www.schmersal.com

